

THE CORINTHIAN is a 4,709 total square foot luxury home featuring four bedrooms with study, four baths, family room and three-car garage. The tiled family room opens to the lanai, pool and spa with zero edge pocket sliding glass doors. The gourmet kitchen is designed with custom stained stepped up cabinets, granite countertops, tumblestone backsplash and equipped with Kitchen-Aide appliances.

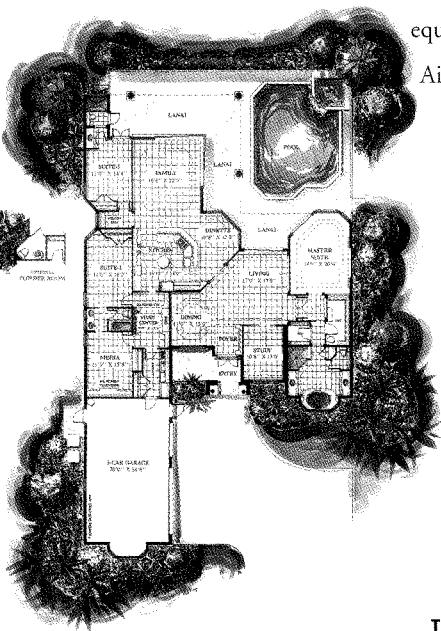

THE CORINTHIAN

Lanai	618 Sq. Ft.
A/C Living Area	3,150 Sq. Ft.
Garage	786 Sq. Ft.
Entry	155 Sq. Ft.
TOTAL	4,709 Sq. Ft.