

The Corinthian II

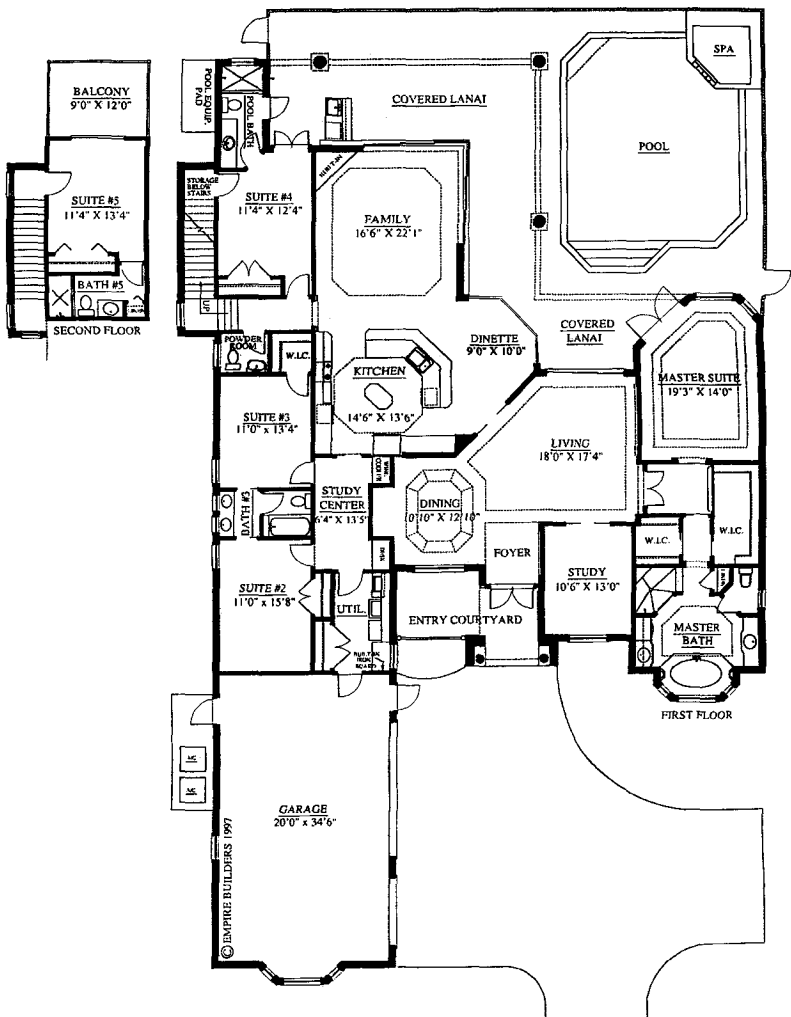

The Corinthian II is a 2-story, 5,167 total square-foot home with 5 bedrooms, 4.5 baths, plus study, family room and 3-car garage. The tiled family room opens to the lanai, pool and spa with zero-edge pocket sliding glass doors. The gourmet kitchen is designed with custom-stained stepped cabinets, granite countertops, tumblestone backsplash and is equipped with KitchenAid® appliances.

The tiled family room opens to the lanai, pool and spa with zero-edge pocket sliding glass doors. The gourmet kitchen is designed with custom-stained stepped cabinets, granite countertops, tumblestone backsplash and is equipped with KitchenAid® appliances.

A/C Living Area	3,500 Sq. Ft.
Lanai	618 Sq. Ft.
Garage	786 Sq. Ft.
Entry	155 Sq. Ft.
2nd-floor balcony	108 Sq. Ft.
TOTAL	5,167 Sq. Ft.